

"Second Joint Meeting of the Society for Pentecostal Studies and the
Wesleyan Theological Society"

*Wesleyan and Pentecostal
Movements
for a New Century:*

Crucial Choices, Essential Contributions

March 20 - 22, 2003

Hosted by
Asbury Theological Seminary
Wilmore, Kentucky

*32nd Annual Meeting of the Society for Pentecostal Studies
38th Annual Meeting of the Wesleyan Theological Society*

THE PROGRAM

As a result of the joint conference there are more pre conference events than are normal for either individual society. Each pre conference event is listed separately rather than by grouping them together. Any last minute changes will be included in the registration packet.

PRECONFERENCE EVENT #1

**Joint Meeting of the Society for the Study of Psychology
and Wesleyan Theology (SSPWT)
and the
Wesleyan Philosophical Society (WPS)**

March 19-20, 2003
Marriott Griffin Gate Hotel, Lexington, KY

Visit <http://www.ptloma.edu/WESLEYAN/SPWT/conference.htm> for updates and a downloadable registration form. For this pre conference event you must register separately at this website.

Member Registration (\$25)

Nonmember Registration (\$35)

Student Registration (\$15)

Fowler Dinner (\$20) - (must be received by March 1st)

Wednesday, March 19, 2003

5:00 - 6:00 p.m. Registration

Dixiana and Lanes End

6:30 - 8:00 p.m. COMBINED PLENARY SESSION

Dinner (reservation required), Welcome & Introduction

Keynote Address:

**“A Proposal Regarding Divine Providence as a Key Resource for
Reclaiming a Viable Doctrine of Vocation in Our Time”**

PRESENTER:

James W. Fowler, Emory University

Dixiana and Lanes End

Thursday March 20, 2003

8:00 - 10:00 a.m. Session #1 (Papers)

SSPWT (1A)	WPS (1B)
<p>“Resonance: A New Approach to the Wesleyan Quadrilateral and a Biblical Case Study” PRESENTERS: Warren Brown, David L. Matson Fuller Theological Seminary School of Psychology</p> <p>“Soul and Mind: Sanctification for the American Evangelical in the Context of Addiction Brain/Behavior Science” PRESENTERS: Michael Boivin, Doug Daugherty, Keith Drury, Keith Puffer Indiana Wesleyan University</p> <p><i>Dixiana</i></p>	<p>“The Book of Job: A Solution to the Problem of Evil Through Religious Experience” PRESENTER: Eric Vogelstein, Colorado University</p> <p>“Divine Immanence and Prevenient Grace” PRESENTER: Randy Auxier, Southern Illinois University</p> <p><i>Lanes End</i></p>

10:00 - 10:30 a.m. Break & Late Registration

10:30 a.m. - 12:30 p.m. Session #2 (Papers)

SSPWT (2A)	WPS (2B)
<p>“Psychological Implications of the Doctrine of Christian Perfection” PRESENTERS: Irv Brendlinger, Eric Mueller George Fox University</p> <p>“Myth and Sanctification: A Psychoanalytic and Theological Analysis” PRESENTER: Mark Reynolds, Vanderbilt University</p> <p>“Being and Becoming Moral” PRESENTER: Rebecca Flietstra, Point Loma Nazarene University</p> <p><i>Dixiana</i></p>	<p>“Hegel and the Contemporary Enterprise In ‘First Philosophy’” PRESENTER: Amos Yong, Bethel College</p> <p>“The Scientific Argument from Religious Experience” PRESENTER: Stephen R. Brown, University of Oklahoma</p> <p><i>Lanes End</i></p>

12:30 - 1:30 p.m. Lunch	
1:30 - 2:30 p.m. Session #3 (Plenaries)	
SSPWT (3A)	WPS (3B)
Invited Address “Can Faith Development Theory Intersect Helpfully with Biblical Hermeneutics and Interpretation?” PRESENTER: James W. Fowler, Emory University <i>Dixiana</i>	Presidential Address “Types of Wesleyan Philosophy: The General Landscape and My Own Research Agenda” PRESENTER: Thomas Jay Oord, Northwest Nazarene University “Wesleyan ‘Personhood’ and the Experience of Deification” PRESENTER: Randy Auxier, Southern Illinois University <i>Lanes End</i>
2:30 - 4:30 p.m. Session #4 (Papers)	
SSPWT (4A)	WPS (4B)
“Postmodern Therapies and Wesleyan Spirituality: An Integrative Theory of Change” PRESENTER: Peter Jankowski, Judson College “Attachment to Parents, Friends, and God: Compensatory and Continuous Models Predicting Adolescent Religious Orientation” PRESENTER: Kelly Schwartz, Nazarene University College “The Psychology of Conversion: The Super and Supra-natural Experiences found in “Harry Potter”” PRESENTER: Rev. Beverly A. Hall, Saint Paul School of Theology <i>Dixiana</i>	“Seeing is not Believing: Non-Believers and Religious Experience” PRESENTER: Jacob Affolter, University of California at Riverside “Religious Experience and the Ethics of Belief: The Clifford-James Debate Revisited” PRESENTER: James Baehr, Baylor University ““Faith, taken in its widest sense”: John Wesley on the Spiritual Senses” PRESENTER: Laura Bartels, Drew University <i>Lanes End</i>
4:30 - 5:30 p.m. SSPWT Business Meeting	4:30 - 5:30 p.m. WPS Business Meeting
<i>Dixiana</i>	<i>Lanes End</i>

PRECONFERENCE EVENT #2

Korean Wesleyan Group (with Korean Pentecostals)

March 19-20, 2003
Marriott Griffin Gate Hotel, Lexington, KY

For additional information, please contact:

Dawk-Mahn Bae (973) 410-9818 ; Dbae@drew.edu or

Meesaeng Lee Choi (859) 858-2046; Meesaeng_Choi@asburyseminary.edu

No Registration Fee

Wednesday, March 19, 2003

8:00 - 9:00 p.m. **SESSION I**

Marriott Griffin Gate Hotel, Lexington, KY

Elmendorf

Thursday, March 20, 2003

10:00 - 11:30 a.m. **SESSION 2**

Marriott Griffin Gate Hotel, Lexington, KY

Elmendorf

1:00 - 3:00 p.m. **SESSION 3**

Marriott Griffin Gate Hotel, Lexington, KY

Elmendorf

PRECONFERENCE EVENT #3

Workshop for Librarians and Archivists
**"If It Isn't Paper: Collecting, Arranging, Preserving and Using
Non-Print Media in Libraries and Archives"**

March 20, 2003
Marriott Griffin Gate Hotel, Lexington, KY

The cost of the workshop is \$25 per person and participants should register for the workshop along with their conference registration.

This workshop is designed for librarians and archivists of both SPS and WTS. Participants will have an opportunity to learn from our guest instructor and each other. Our guest instructor will be Ms. Lisa Carter, Audio-Visual Archivist at the University of Kentucky. Ms. Carter is responsible for a collection that presently consists of over 9,000,000 feet of film, 6,500 videotapes, 12,000 sound recordings and 500,000 photographs. She is an author and teacher as well as a frequently requested speaker in her field.

*For additional information, please contact: David G. Roebuck
Dixon Pentecostal Research Center, 260 11th Street NE, Cleveland, TN 37311.
Tel: (423) 614-8555. droebuck@leeuniversity.edu*

Thursday, March 20, 2003

12:30 - 1:00 p.m. Registration

Calumet and Darby Dan

1:00 - 2:45 p.m.

Welcome & Introductions

"Technical Difficulties: Challenges of Using and Preserving Audio-Visual Information"

PRESENTER:

Lisa Carter, University of Kentucky

Calumet and Darby Dan

2:45 - 3:00 p.m. Break

Thursday, March 20, 2003

3:00 - 3:45 p.m.

“Between the Times: Moving between a Print Past and a Digital Future”

PRESENTER:

Lisa Carter, University of Kentucky

Calumet and Darby Dan

3:45 - 5:00 p.m.

“Real World Challenges/Real World Solutions”

PRESENTER:

Kate McGinn, Free Methodist Church Archives
Panel discussion followed by a group conversation

Calumet and Darby Dan

PRE CONFERENCE EVENT #4

DIVERSITY GROUP

3:00 - 5:00 p.m.

“Holiness, Healing and Anthrax”

PRESENTER:

Cheryl J. Sanders, Howard University

CHAIR:

Jenny Powers, Hope College

REPRESENTANTS:

Daniel Ramirez, Duke University
Arlene Sanchez Walsh, De Paul University
Leslie D. Callahan, University of Pennsylvania

No Registration Fee

A & B

PRE CONFERENCE EVENT #5

CATHOLIC PENTECOSTAL DIALOGUE

3:00 - 5:00 p.m.

"The Time has Come: Latin American Pentecostals and Catholics in Dialogue"

A report by participants representing the Latin American Bishops Conferences (CELEM), the Latin American Council of Churches (CLAI), and the Evangelical Commission of Latin American Pentecostals (CEPLA)

CO-CHAIRS:

Cheryl Bridges Johns, Church of God Theological Seminary
Jeffrey Gros, US Conference of Catholic Bishops

No Registration Fee

G & H

CONFERENCE BEGINS

5:00 - 7:00 p.m. Registration

Lobby Alcove

7:00 - 9:00 p.m. Plenary Session 1

THEME: Mission and Renewal

"The Babylonian Captivity of Wesleyan Theology"

PRESENTER:

Howard A. Snyder, Asbury Theological Seminary

"Holistic Church Mission: Pentecostal Perspectives"

PRESENTER:

Murray W. Dempster, Vanguard University

CHAIR:

Carmelo Alvarez, Christian Theological Seminary

A - D

9:00 - 10:00 p.m. Reception

Lobby Alcove

Friday, March 21, 2003

8:00 - 9:15 a.m. Plenary Session 2

THEME: Biblical Perspectives

“Contribute or Capitulate? Wesleyans, Pentecostals, and Reading the Bible in a Postcolonial Mode”

PRESENTER:

Joel B. Green, Asbury Theological Seminary

“Honoring Our Hermeneutical Heritage: How Pentecostal and Holiness Hermeneutics Have Empowered and Can Continue to Empower Women for Ministry”

PRESENTER:

Janet Everts Powers, Hope College

CHAIR:

John Christopher Thomas, Church of God Theological Seminary

A - D

9:15 - 9:45 a.m. Break

9:45 - 11:00 a.m. Parallel Session 1

TITLE	PRESENTER(S)	ROOM	CHAIR	RESPONDENT
“Messiah Without Anointing: A Missing Element in Cinematic Portrayals of Jesus”	Blaine Charette, Northwest College	A - C	Ruth Anne Reese, Asbury Theological Seminary	William Malas, Eastern Nazarene College
“The Tacit Dimension in Evangelical Trinitarian Theology”	Fred Sanders, Biola University	Lanes End	Melissa Archer, Lee University	Laurence Wood, Asbury Theological Seminary
“The Kingdom of God and the Epistemology of Systems Theology”	Bill Buker, Oral Roberts University	Dixiana	Ed Decker, Oral Roberts University	Chris Adams, Fuller Seminary School of Psychology
“Pentecostal Presence in Broadcast Media”	Kirk Lyons, New York Theological Seminary	Darby Dan	Ken Boyd, Asbury Theological Seminary	Vinson Synan, Regent University
“‘Worlds Apart’: Maintaining Religious Identity Among Multicultural Evangelical Youth”	Arlene Sanchez Walsh, DePaul University	F	Cathy Stonehouse, Asbury Theological Seminary	Anthea Butler, Loyola Marymount University
“Jesus: God of the Hindus”	Happy Alexander, Southern Methodist University	Calumet	Mathias Zahniser, Asbury Theological Seminary	Paul Alexander, Southern Methodist University

9:45 - 11:00 a.m. Parallel Session 1 *Continued*

TITLE	PRESENTER(S)	ROOM	CHAIR	RESPONDENT
Theme: The Use of Transportation Technology Among Holiness-Pentecostal Evangelists.				
"The Revival Train': Railroads as Reality and Metaphor in the Holiness-Pentecostal Movement, 1875—1925"	Daniel Woods, Ferrum College	E	David Roebuck, Dixon Pentecostal Research Center, Cleveland, TN	No respondent due to time limit.
"Bread Upon the Waters: The I.R.B. Arnold Family and the 'Floating Chapel'"	Gari-Anne Patzward, Lexington, KY			
"The Pneumatological Contributions of Yves Congar to Current Ecumenical Dialogue: Toward a Roman Catholic and Wesleyan/Pentecostal Theological Discourse"	Richard Eckley, Houghton College	G	Sharon Pearson, Anderson University	Don Thorsen, Azusa Pacific University
"David Yonggi Cho and International Pentecostal/Charismatic Movements"	Myung Soo Park, Seoul Theological Seminary	H	Hunn Choi, Lutheran School of Theology	Elaine Heath, Duquesne University

11:00 - 11:10 a.m. Break

11:10 a.m. - 12:25 p.m. Parallel Session 2

TITLE	PRESENTER(S)	ROOM	CHAIR	RESPONDENT
"A Johanine Model for Outreach: John 14: 12-21 as a Model for a Wesleyan Understanding of Mission to a Postmodern World"	Russell Morton, Ashland Theological Seminary	H	Hannah Kirsch, Asbury Theological Seminary	Jon Rutven, Regent University
"A Call to Conversion: The Spirit, A Pentecostal, and Elizabeth Johnson"	Pamela Holmes, Wycliffe College	E	Jackie Johns, Church of God Theological Seminary	Lydia Hoyle, Georgetown College
"The Wesleyan Preacher in Post-modernity"	Christopher Wade Branard, Pastor of the New Begin- ning Church of the Naza- rene, North Canton, OH	F	Michael Thompson, Northwest College	No respondent due to time limit.
"Preaching as Play: Psychoanalysis and Homiletic in Dialogue"	Brad D. Strawn, Point Loma Nazarene University Brent A. Strawn, Emory University			

11:10 a.m. - 12:25 p.m. Parallel Session 2 Continued

TITLE	PRESENTER(S)	ROOM	CHAIR	RESPONDENT
"The Mode of Divine Knowledge in Reformation Arminianism and Open Theism"	Steven Studebaker, Marquette University	Lanes End	Thomas Jay Oord, Northwest Nazarene University	Randy Auxier, Southern Illinois University
"Charisma and Culture: An Analysis of Charisma Magazine and Its Portrayal of Contemporary Pentecostalism"	Thomas C. Hood, University of Tennessee at Knoxville	Dixiana	Lee Cheeks, Lee University	Karen Carroll Mundy, Lee University
"The Depiction of Missionaries in Popular 20th Century Novels"	J. Matthew Price Church of the Nazarene Educational Ministries	Darby Dan	Jason Vickers, Southern Methodist University	Kenneth Rowe, Drew University
"A Tercentenary Celebration of John Wesley: A Mentor For Us All"	Kenneth Collins, Asbury Theological Seminary	A - C	Panel Discussion, Asbury Theological Seminary: Paul Chilcote, Alan Coppedge, Howard Snyder, Robert Tuttle, Lawrence Wood	
"Supernatural Physical Manifestations in Evangelical and Holiness Movements"	Paul L. King, Oral Roberts University	Calumet	Meesaeng Lee Choi, Asbury Theological Seminary	Scott T. Kisker, Wesley Theological Seminary
"The Fellowship of the Spirit: Intersubjectivity by Participation"	Christopher P. Momany, Adrian College	G	David Reed, Wycliffe College	Harold Hunter, International Pentecostal Holiness Church Archives

12:35 - 1:50 p.m. Lunch Break

SPS Interest Group Meetings:

Biblical Studies: Blaine Charette, Chair - Salons A-C

Historical Studies: Wayne Warner, Chair - Salon E

Philosophy: Jack Wisemore, Chair - Darby Dan

Theology: Terry Cross, Chair - Calumet

Practical Theology/Christian Formation: Ed Decker, Chair - Salon H

Mission & Intercultural Studies: Robert L. Gallagher, Chair - Dixiana

Ecumenical Studies: Wolfgang Vondey, Chair - Lanes End

Religion & Culture: David Daniels, Chair - Salon F

2:00 - 3:15 p.m. Parallel Session 3				
TITLE	PRESENTER(S)	ROOM	CHAIR	RESPONDENT
"Holiness as an Aspect of the Spirit's Work in the Book of Numbers"	Roger Cotton, Assemblies of God Theological Seminary	E	Karen Strand Winslow, Greenville College	John Stanley, Messiah College
"Justification: Fount of Justice"	Chad Maxson, Olivet Nazarene University	Darby Dan	Brian Hartley, Greenville College	Harry Cross, Lee University
"Introducing Pentecostals to the Ministry of Spiritual Direction"	Jay Herndon, Three Cities Assemblies of God	Calumet	Peter Althouse, University of Toronto	Douglas S. Hardy, Nazarene Theological Seminary
"Why Pamphilus Matters: Religious Education in Hume's Dialogues "	Jason Swedene, Lake Superior State University	A - C	Brint Montgomery, Southern Nazarene University	No respondent due to time limit.
"A Pentecostal Hermeneutical Strategy: Spirit, Community and Scripture"	Kenneth Archer, Church of God Theological Seminary			
"Yanking Out the 'Royal Telephone': Convert Agency in Borderlands Methodism and Pentecostalism"	Daniel Ramirez, Duke University	F	Raynard Smith, Drew University	Zaida Perez, Asbury Theological Seminary
"An Analysis of the International House of Prayer's Scriptural Hermeneutic of Intercession and Subsequent Practice"	Bryan Hudkins, Wheaton College Graduate School	Dixiana	Ken Gill, Billy Graham Center, Wheaton College	Russell West, Asbury Theological Seminary
TITLE: "Controversies Related to Late 19th/Early 20th Century Holiness-Pentecostal Believers"				
"The Corsicana Enthusiasts: A Pre-Pentecostal Millennial Sect"	Barry Hamilton, Northeastern Theological Seminary	Lanes End	Wayne Warner, Assemblies of God	No respondent due to time limit
"In Prison For Christ's Sake': Divine Healing Trials and the Church of God (Anderson)"	Michael Stephens, Vanderbilt University			
"Toward a Pentecostal Form of Thought: The Ecumenical Future of the Society for Pentecostal Studies"	Wolfgang Vondey, Marquette University	G	James Shelton, Oral Roberts University	Anthea Butler, Loyola Marymount University
"The Wesleyan Revival as a Model for the Convergence Movement"	William L. DeArteaga, St. Jude's Episcopal Church	H	Steve Rankin, Southwestern College	Ron Crandell, Asbury Theological Seminary
3:15 - 3:45 p.m. Break				

3:45 - 5:00 p.m. Plenary Session 3

WTS Presidential Address
“Visions of the ‘God in us’: Orthodox Themes in the Methodist, Holiness and Pentecostal Movements”

PRESENTER:
David Bundy, Fuller Theological Seminary

CHAIR:
Ralph Del Colle, President of the Society for Pentecostal Studies

A - D

5:10 - 6:00 p.m. SPS Business Meeting

A - D

5:10 - 6:00 p.m. WTS Business Meeting

E - F

6:00 - 7:30 p.m. Dinner

7:30 - 8:45 p.m. Plenary Session 4

THEME: Christian Formation

**“Communities of Holiness, Communities of the Spirit:
Developing an Ecclesial Conversation for Discipleship”**

PRESENTER:
Dean G. Blevins, Trevecca Nazarene University

“From Strength to Strength: A Vision for the Formation of Pentecostal Christians”

PRESENTER:
Cheryl Bridges Johns, Church of God Theological Seminary

CHAIR:
Randy L. Maddox, Seattle Pacific University

A - D

Saturday, March 22, 2003

8:30 - 9:45 a.m. Plenary Session 5

THEME: HISTORICAL PERSPECTIVES

“Gendered Sin? Gendered Holiness? Historical Consideration and Homiletical Implications”

PRESENTER:

Diane Leclerc, Northwest Nazarene University

“‘God Rode in the Windstorm’: The Vocation of a Historian after Christendom”

PRESENTER:

David D. Daniels, McCormick Theological Seminary

CHAIR:

Douglas M. Strong, Wesley Theological Seminary

McKenna Chapel

9:45 - 10:15 a.m. Break

McKenna Foyer

10:15 - 11:30 a.m. Parallel Session 4

TITLE	PRESENTER(S)	ROOM	CHAIR	RESPONDENT
“Holiness and New Life in Christ: A Rhetorical Overview of Romans 6-8”	Jeffrey S. Lamp, Oral Roberts University	MC304	David Bauer, Asbury Theological Seminary	Alan Brown, God’s Bible School
“Seek My Face, Seek My Name: Openness and Oneness Theology in Dialogue”	Marion Millner, Harvard Divinity School	SH231	Brad T. Noel, University of South Africa	Kenneth Bass, Baylor University
“Why Experience Matters: Pragmatism and Wesleyan Theology”	Matt Price, Faculte de Theologie de l’Eglise du Nazareen, Cote d’Ivoire, West Africa	SH230	Dean G. Blevins, Trevecca Nazarene University	Ed Robinson, Nazarene Theological Seminary
Panel: “The Future of Practical Theology in Wesleyan and Pentecostal Perspective”	Douglas S. Hardy, Ed Decker, Ed Robinson			
“Why Are Some Not Healed? Atonement Paradigms, Divine Healing and an Insight from Edward Irving”	Skip Jenkins, Marquette University	MC306	Barry Bryant, Memphis Theological Seminary	Kevin Timpe, Saint Louis University
“An Ecumenism of the Spirit: An Alternative Interpretation of Glossolalia”	Estrela Alexander, Regent University	BC231-232	Kevin Mannoia, Azusa Pacific University	Frank Macchia, Vanguard University

10:15 - 11:30 a.m. Parallel Session 4 Continued

TITLE	PRESENTER(S)	ROOM	CHAIR	RESPONDENT
"Missions and the Missing (Person): Implications of De-Personalizing Pneumatology in Pannenberg and Cobb"	Kenton M. Stiles, Graduate Theological Union	CM202	Sang-Ehil Han, Church of God Theological Seminary	Craig Keen, Olivet Nazarene University
"Liberation Theology: An Ecclesiological Charism for Latin American Pentecostalism"	Tim Klingler, Fuller Theological Seminary	SH408	Enrique Zone, Azusa Pacific University	Doug Peterson, Vanguard University
"An Analysis of the Ministry of Paul Yongi Cho"	Myung Soo Park, Seoul Theological Seminary	SH404	Stanley Burgess, Southwest Missouri State University	Daniel Flores, Drew University
"Eucharist, Religious Experience, and the Trace of God"	Eric Severson, Grandview Church of the Nazarene	CM302	Larry Smith, God's Bible School	Elizabeth Mellen, Episcopal Church

11:30 a.m. - 12:45 p.m. Lunch Break

12:45 - 2:00 p.m. Plenary Session 6

SPS Presidential Address

"Aesthetics and Pathos in the Vision of God: A Catholic/Pentecostal Encounter"

PRESENTER:

Ralph Del Colle, Marquette University

CHAIR:

David Bundy, President of the Wesleyan Theological Society

McKenna Chapel

2:00 - 2:15 p.m. Break

McKenna Foyer

2:15 - 3:30 p.m. Parallel Session 5

TITLE	PRESENTER(S)	ROOM	CHAIR	RESPONDENT
"Communal Holiness: An Afro-centric Perspective on Sanctification in 1 Corinthians"	Ayodeji Adewuya, Church of God Theological Seminary	CM202	Woodrow Whidden, Andrews University	Richard Thompson, Olivet Nazarene University
"Purity, Power, and Pentecostal Light: The Holiness/Pentecostal Theology of A.M. Hills"	Christopher Bransetter, Drew University	CM302	Wally Thornton, Moberly, Church of the Nazarene	Paul Bassett, Nazarene Theological Seminary
"The Use of Wesley's Theology and Praxis of Sanctification in Pastoral Counseling"	Kathleen M. Haley, Saint Paul School of Theology	CM304	Judith Schwartz, Nazarene Theological Seminary	Virginia Todd Holeman, Asbury Theological Seminary

2:15 - 3:30 p.m. Parallel Session 5 Continued				
TITLE	PRESENTER(S)	ROOM	CHAIR	RESPONDENT
"Zerah & Perez, Supervenience, and Systematic Evil: An Exploration from Genesis 38: 27-30"	Brint Montgomery, Southern Nazarene University Robert J. Thompson, Northwest Nazarene University	SH231	Jack Wisemore, Northwest College	Craig Boyd, Greenville College
"Heaven Below"	Grant Wacker, Duke University	BC231-232	Bill Faupel, Asbury Theological Seminary (Chair). Panel: Douglas Jacobsen, Messiah College; Vinson Synan, Regent University; Everett Wilson, Bethany College	
"The Hebraic Covenant as a Model for Contextualization"	Robert Gallagher, Wheaton College	SH404	Rickie D. Moore, Church of God Theological Seminary	Bill Arnold, Asbury Theological Seminary
"Guidelines for a Challenging Dialogue with Pentecostals: Lessons from the Netherlands"	Paul van der Laan, Southeastern College	CM306	David Bundy, Fuller Theological Seminary	(Tentative) David Zampino, Marquette University
"Mapping the Missionary Impulse of Early African American Pentecostals in the Southwest: The Texas Case"	Karen Kossie-Chernyshev, Texas Southern University	SH408	Steven O'Malley, Asbury Theological Seminary	Estrela Alexander, Regent University
"The Working of the Spirit in the Creation and in the People of God: An Outline of the Pneumatology of Wolfhart Pannenberg"	Veli-Matti Kärkkäinen, Fuller Theological Seminary	SH230	Ian Levy, Lexington Theological Seminary	Chuck Gutenson, Asbury Theological Seminary
3:30 - 3:45 p.m. Break <i>McKenna Foyer</i>				
3:45 - 5:00 p.m. Parallel Session 6				
TITLE	PRESENTER(S)	ROOM	CHAIR	RESPONDENT
"No Holiness That is Not Social: Pienreice Bourdieu's 'Doxa' and the Call for Social Justice"	Mitchell W. Modein, Drew University	CM302	Charles Jones, Reformed Episcopal Church	Bill Kostlevy, Asbury Theological Seminary
"Nourishment for Our Journey: The Wesleyan Pentecostal 'Via Salutis' and Sacramental Ordinances"	Ken Archer, Church of God Theological Seminary	CM202	Jennifer Woodruff, Drew University	Lester Ruth, Asbury Theological Seminary
"A Wesleyan-Pentecostal Perspective of Counseling"	Oliver MacMahan, Church of God School of Theology	CM306	Bill Baker, Oral Roberts University	Philip R. Budd, Southern Nazarene University

3:45 - 5:00 p.m. Parallel Session 6 *continued*

TITLE	PRESENTER(S)	ROOM	CHAIR	RESPONDENT
"The Role of the Holy Spirit in Transformational Learning"	Frances a Payette, Southern Seminary	CM304	Beverly Johnson-Miller, Asbury Theological Seminary	Clair Budd, Asbury College
THEME: Controversies Related to Late 19th/Early 20th Century Holiness-Pentecostal Believers.				
"The Corsicana Enthusiasts: A Pre-Pentecostal Millennial Sect"	Barry W. Hamilton, Northeastern Seminary	SH408	Kimberly Alexander, Church of God School of Theology	No respondent due to time limit.
"'In Prison for Christ's Sake': Divine Healing Trials and the Church of God (Anderson)"	Michael S. Stephens, Vanderbilt University			
"Contested Indigeneity: The Four-Square Gospel in the Theology of African Initiated Churches"	Robert K. Lang'at, Drew University	SH404	Dale Irvin, New York Theological Seminary	Donald W. Dayton, Azusa pacific University
"Charisma and Structure in The Assemblies of God: Revisiting O'Dea's Five Dilemmas"	Margaret M. Poloma, The University of Akron	SH231	Christine Pohl, Asbury Theological Seminary	Tom Moore, Asbury College
"The Church in Ecumenical Dialogue: Crucial Choices, Essential Contributions"	Jeffrey Gros, US Conference of Catholic Bishops	BC231-232	Ralph Del Colle, Marquette University	Paul M. Bassett, Nazarene Theological Seminary, Amos Yong, Bethel College
"Strategic Level Spiritual Warfare: A Modern Mythology?"	Michael Reid, International Communion of Charismatic Churches	SH230	Tom Mathew, Oral Roberts University	Steve Seamands, Asbury Theological Seminary

7:00 - 9:00 p.m. Banquet
Salons A - D

Introduction of Officers
 Acknowledgement of Retiring Officers
 Dedication of Conference Papers
 Acknowledgement of recently deceased members
 Book of the year awards
 Life-time Achievement Award, **Dr. Charles E. Jones**

ACCOMODATIONS

The meeting hotel will be the Marriott's Griffin Gate Resort, 1800 Newtown Pike, Lexington, Kentucky, 40511 (Tel: 859-231-5100, Fax: 859-231-5136).

Meeting attendees must arrange their accommodations directly with the hotel.

To receive the meeting rate of \$75, participants must fulfill two conditions when they are calling the hotel:

- A. Mention that you are with the "Society for Pentecostal Studies/Wesleyan Theological Society" when reserving your room;
- B. Reserve rooms no later than February 15, 2003.

(The hotel will be reserved from Wednesday, March 19, 2003 to Sunday, March 23, 2003. If there are those who wish to stay longer, the rates will need to be negotiated with the hotel.)

Request non-smoking and room-size preference (single or double) when reserving rooms. (Indicate on the registration form if you are willing to share a room with another meeting attendee.)

TRANSPORTATION & DIRECTIONS

Shuttle service:

The Marriott's Griffin Gate Resort provides shuttle service to and from the Lexington Blue Grass airport. There is a courtesy phone at the airport, or you can schedule the shuttle to pick you up in advance by calling 1-859-231-5100 with your flight details.

Directions from Lexington Blue Grass Airport to the Marriott's Griffin Gate Resort:
Take a left on Man-O'-War from Airport Parking Area. Go East on Versailles Road to Second New Circle Road Exit. Follow New Circle Road to Newtown Pike exit North toward I-64 & I-75. Follow Newtown Pike for approximately 1.5 miles. Resort entrance is on the right.

Directions from the Marriott's Griffin Gate Resort to Asbury Theological Seminary:
Depart the hotel on SR-922, Newtown Pike south. At SR-4 SR-922 Exit, bear right (west) onto SR-4, New Circle Road NW. At SR-4 US-68 Exit, bear Right (South-West) onto US-68, Harrodsburg Road. Continue (South-West) on SR-29, Lexington Road. Continue (South) on SR-29, N. Lexington Avenue.

Coach transportation to Asbury Theological Seminary, Saturday:

There are coaches to transport attendees to Asbury Theological Seminary on the Saturday. The coaches will leave the hotel at 7.45 am, and will leave the seminary at 5.00 pm.

MEALS

Participants are on their own for all meals except the following:

1. If you are planning to attend an interest group session at the Friday noon hour, you should purchase a box lunch.
2. If you are planning to eat at the Asbury Dining Commons at noon on Saturday you will need to purchase a ticket in advance (there are a few places to eat within walking distance to Asbury).
3. If you are planning to attend the Saturday night banquet at the Marriott, you will need to purchase a ticket in advance.

EXHIBITORS AT THE MEETING

Publishers, ministries, and other vendors are welcome to sponsor events at the Meeting. Both full and associate sponsorships give sponsors complimentary exhibitor privileges and official recognition at the meeting.

The SPS/WTS Conference affords a rare opportunity to reach the largest gathering of thought leaders of the Wesleyan and Pentecostal-charismatic movements.

Receive a packet with full sponsorship details by calling D. William Faupel at (859) 858-2226 or sending an e-mail to bill_faupel@asburyseminary.edu. Please include your mailing address and fax and phone numbers in your phone message or e-mail.

COPYRIGHT NOTICE

All papers are copyrighted, 2003, by their authors; and all rights are reserved to the authors. By submitting papers to the **Conference**, authors grant **each Society** the right to reproduce the papers for the current Annual Meeting for online purchase and in one binding for sale at the Meeting, to libraries and other purchasers. Authors further grant **each Society** the right to microfilm Meeting papers as a set and to sell or give duplicates of the microfilm as **either Society** sees fit.

Annual Meeting papers, whether at the SPS Web site or in printed, bound form, are provided for private, non-commercial use, and all other reproduction and all other uses are expressly prohibited without the author's express written permission. Purchasing a bound set of papers or purchasing online electronic copiers of the papers constitutes the user's agreement to use them only in this manner.

THE OFFICERS OF THE WESLEYAN THEOLOGICAL SOCIETY FOR 2002 - 2003 ARE AS FOLLOWS:

President: *David Bundy*
First Vice-President: *Henry H. Knight III*
Second Vice-President: *Philip R. Meadows*
Immediate Past-President: *Sharon Clark Peterson*
Secretary/Treasurer: *William C. Kostlevy*
Promotional Secretary: *Thomas J. Oord*
Editor: *Barry L. Callen*

Editorial Committee: *David Bundy, Stanley Ingersol*
Nominating Committee: *Steve McCormick, Elbert Trusedale, Douglas Strong, Wes Tracy.*

THE OFFICERS OF THE SOCIETY FOR PENTECOSTAL STUDIES FOR 2002-2003 ARE AS FOLLOWS:

President: *Ralph Del Colle*
First Vice President: *Steven J. Land*
Second Vice President: *Anthea Butler*
Immediate Past President: *Samuel Solivan*
Executive Secretary: *D. William Faupel*
Editor: *Frank D. Macchia*
Web Master: *Harold Hunter*

Editorial Committee: *Amos Yong, Dale Irvin, J. L. Hall, Ken Gill, Renard Smith*
Nominating Committee: *Sherry DuPree, Rebecca Skaggs, Chris Thomas*
Membership Committee: *Kimberly Alexander, Talmage French, Suzie Hiatt, Ken Archer, Angela Aubry, Michael Dusing*
Library and Archives Committee: *David Roebuck, Mark Roberts*
Diversity Group: *Jenny Powers, Marlon Miller, Arlene Sanchez Walsh*

REGISTRATION

Please print this form, complete it, and mail it with funds in \$US (no currency; send checks or money orders only) payable to the Society for Pentecostal Studies to the address at the end of the form. Save money by mailing your registration complete with payment by February 15, 2003.

Registration Form for the Second Joint Meeting of the
Society for Pentecostal Studies and the Wesleyan Theological Society
March 20—23, 2003.
Asbury Theological Seminary, Wilmore, Kentucky

1. CHOOSE THE CORRECT REGISTRATION FEE:

- WTS or SPS member, registration postmarked by Feb. 15, 2003\$50
- WTS or SPS member, registration postmarked after Feb. 15, 2003\$60
- Non-member, registration postmarked by Feb. 15, 2003\$60
- Non-member, registration postmarked after Feb. 15, 2003 \$70
- Full-time student, registration postmarked by Feb. 15, 2003 \$25
- Full-time student, registration postmarked after Feb. 15, 2003 \$35

*If you wish to apply for membership in either society (see 5 and 6 below), \$10 of the Non-member registration fee will apply towards your first-year membership dues (This does not apply to the Full-time student. They pay the registration fee plus the Student Membership Fee).

Write your fees
in this column

\$ _____

2. BOXED LUNCHESES: (For Interest Group Sessions)

Friday, March 21 - The cost will be \$9.00.
Orders must be received by March 15, 2002.

\$ _____

3. BUFFET LUNCH AT THE ASBURY DINING COMMONS

Saturday, March 22 - The cost will be \$6.00.
Orders must be received by March 15, 2002.

\$ _____

4. REQUEST A BANQUET TICKET

This Banquet is at the Marriott Hotel, Saturday, March 22, 2002 at 7.00 p.m.
The cost will be \$30
Orders must be received by March 15, 2002.

\$ _____

<p>5. RENEW WTS MEMBERSHIP:</p> <p><input type="checkbox"/> Full Membership \$30</p> <p><input type="checkbox"/> Student Membership \$10</p> <p><input type="checkbox"/> I wish to apply for Membership and ask you to forward my registration information to the WTS Executive Secretary. I have also checked the level of membership in this box for which I am applying and am enclosing the payment that corresponds to that level, less \$10 (see 1. above.) (Does not apply to Student Rate).</p>	<p>\$ _____</p>
<p>6. RENEW SPS MEMBERSHIP:</p> <p><input type="checkbox"/> Full Membership \$35</p> <p><input type="checkbox"/> Associate Membership ... \$35</p> <p><input type="checkbox"/> Student Membership \$15</p> <p><input type="checkbox"/> I wish to apply for Membership and ask you to forward my registration information to the SPS Executive Secretary. I have also checked the level of membership in this box for which I am applying and am enclosing the payment that corresponds to that level, less \$10 (see 1. above.) (Does not apply to Student Rate).</p>	<p>\$ _____</p>
<p>7. RESERVE A BOUND SET OF THE PAPERS PRESENTED AT THE MEETING:</p> <p><input type="checkbox"/> Request received by March 15, 2002 - \$50 each</p>	<p>\$ _____</p>
<p>8. TRANSPORTATION</p> <p><input type="checkbox"/> I will need to use the coach to go to Asbury Seminary on Saturday, March 22.</p> <p><input type="checkbox"/> I plan to go by car to Asbury Seminary on Saturday, March 22.</p>	<p>\$ No Charge</p>
<p>9. REGISTRATION FEES FOR WORKSHOP FOR LIBRARIANS AND ARCHIVISTS</p> <p><input type="checkbox"/> I will be attending the workshop on Thursday, March 20, 2003. The Cost will be \$25</p>	<p>\$ _____</p>
<p>10. TOTAL THE PAYMENT and mail with Registration:</p> <p>Payable by check or money order in \$US to <i>Society for Pentecostal Studies</i></p>	<p>\$ _____</p>

11. PROVIDE PERSONAL INFORMATION—Please print neatly:

Name _____
Institution _____
Mailing Address _____
City _____ State/Province _____ Zip/Postal Code _____
Country _____ Office Telephone _____ Home Telephone _____
Fax _____ Email _____ WTS Member SPS Member

12. SHARING A HOTEL ROOM

_____ M _____ F Initial and circle the correct gender if you are willing to share a hotel room with another Meeting attendee and if you authorize SPS/WTS to give your name, phone number, and email address to another attendee of the same gender who wishes to consider sharing a room with you; otherwise ignore this item. SPS/WTS does not reserve rooms for any attendee. SPS/WTS will only help attendees who want to share room to communicate among themselves.

_____ Initial here if you need special accommodations during the Meeting because of disability. Please explain, or ask us to call you.

- Special Note: SPS/WTS cannot be financially responsible if a roommate cannot be secured or if a roommate does not show up for the meeting. You will be responsible to contact the attendee yourself.
- Only persons wearing registration nametags will be admitted to meeting sessions.
- Please mail this 2003 Joint Meeting Registration Form with enclosed payments (checks or money orders in \$US only) to:
D. William Faupel
Executive Secretary
The Society for Pentecostal Studies
P.O. Box 23395
Lexington, KY 40523-3395
- You can also register online by logging in to: www.sps-usa.org/meetings/2003reg.html
- If you have any questions, please contact the Registrar, Jennie Hopper by phone (859) 858-2229, fax (859) 858-2350, or e-mail jennie_hopper@asburyseminary.edu

FINDING YOUR CONFERENCE SESSIONS AT ASBURY THEOLOGICAL SEMINARY

- 9 McKenna Chapel
- 4 Stanger Hall (SH230, SH231, SH404, SH408)
- 11 Beeson Center (BC231 - BC232)
- 19 Crary-McPheeters Building (CM202, CM302, CM304, CM306, CM308)

For those driving, park in lots B, C, A, and Q.

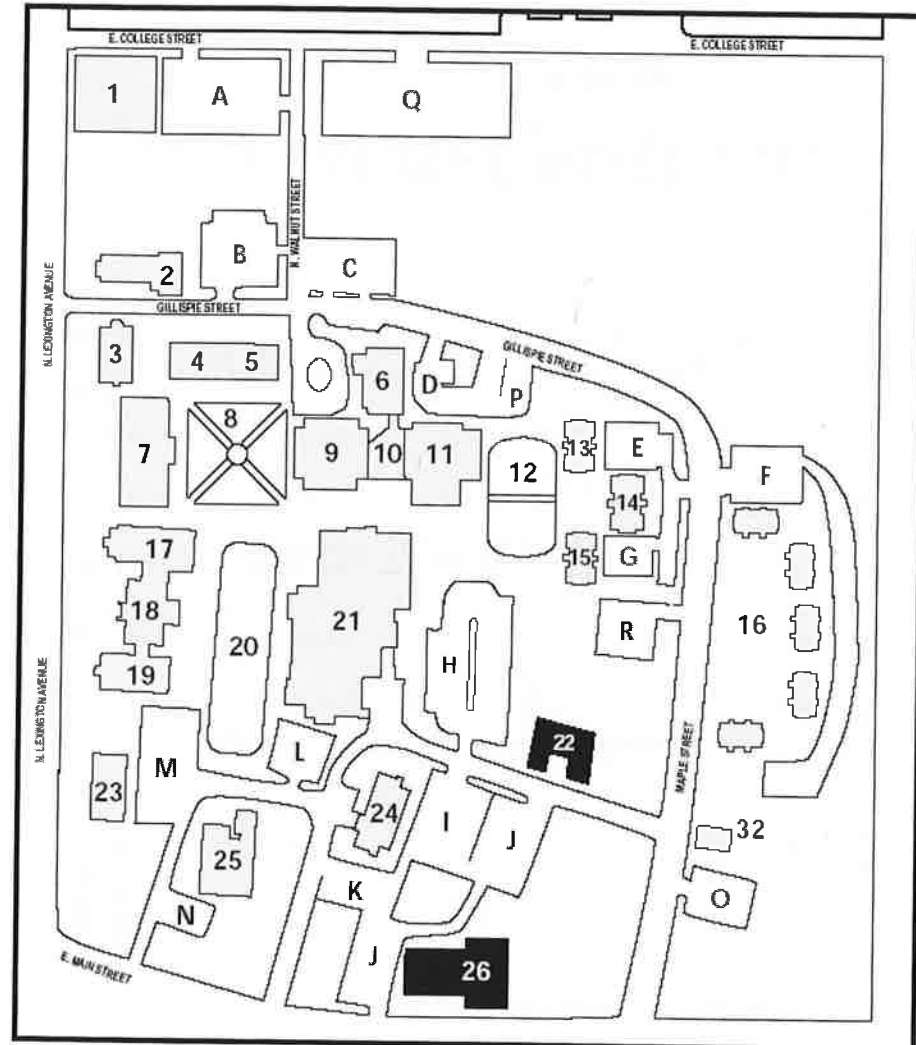

For more information on Asbury Theological Seminary visit their website at www.asburyseminary.edu

Society for Pentecostal Studies
Joint WTS/SPS Meeting
P. O. Box 23395
Lexington, KY 40390
USA

Return Service Requested

Non-Profit Org.
U.S. Postage
PAID
Permit No. 1
Lexington, KY